



## K2 HIGH CAPACITY LFP 26650 E-3750-11 ENERGY CELL DATA



UNDOT 38.3 Tested | RoHS Compliant  
UL1642 | IEC 62133\*\*

### SPECIFICATIONS

Nominal Capacity (Ah) @ C/5	3.75
Average Operating Voltage (V) @ C/5	3.20
Internal Impedance (mΩ) @ 1kHz, AC	≤20
Weight (g/oz)	88 ± 2

### RECOMMENDED OPERATING CONDITIONS

Continuous Discharge (A) @ C	≤3.75
Pulse Discharge (A) @ 30 sec, 4C	15.00
Charge Current (A) @ C/2	≤1.85
Charge Voltage Cutoff (V)	3.65
Discharge Voltage Cutoff (V)	2.30
High Operating Temperature (°C)	60.00
Low Operating Temperature (°C)	0.00

### MAXIMUM OPERATING CONDITIONS

Continuous Discharge (A) @ C	20.00
Pulse Discharge (A) @ 30 sec, 4C	30.00
Charge Current (A) @ C/2	3.75
Charge Voltage Cutoff (V)	3.90
Discharge Voltage Cutoff (V)	2.00
High Operating Temperature (°C)	65.00
Low Operating Temperature (°C)	-20.00

Performance may vary depending on application. All specifications and operation conditions are subject to change without notice. No guarantee is intended or implied by this data. Rev\_A

\*May reduce cycle life

\*\*Charge above 0°C for best life

### DIMENSIONS:

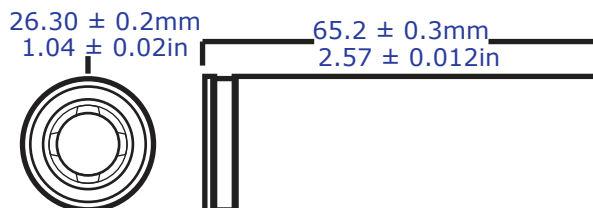

### LFP26650E-3750-11 Discharge Rates at 23°C

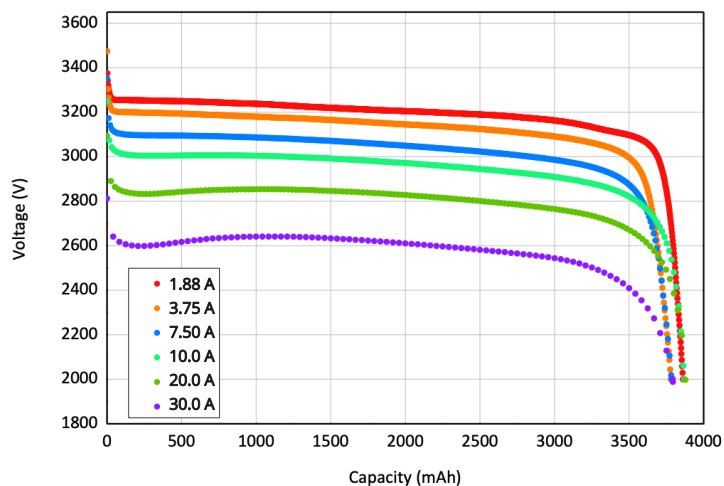

### LFP26650E-3750-11 Cycle Life (3.75A Charge - 3.95A Discharge)

